



**AUSTRALIS
ENGINEERING**

Bucket Elevators



Bucket Elevators - Conveyor Systems - Palletisers

Pallet Handling - Special Purpose Equipment

MULTI-AXIS ELEVATOR



Australis Engineering are the **exclusive** Global Mining Industry partner, as well as Australian, New Zealand and Asia-Pacific agent for Gough Econ Inc. equipment .

MULTI-AXIS ELEVATOR

The Elecon is the world's only conveyor that can move materials in all three directions.

Besides the typical vertical and horizontal movement, the Elecon's buckets actually turn corners!

No other conveying system in the world is as flexible as the Elecon.

This 3-axis capability is a result of its patented chain design and wedge-shaped buckets. Because it's so flexible, the Elecon system can handle virtually any circuit design you can imagine including multiple infeed and discharge points.

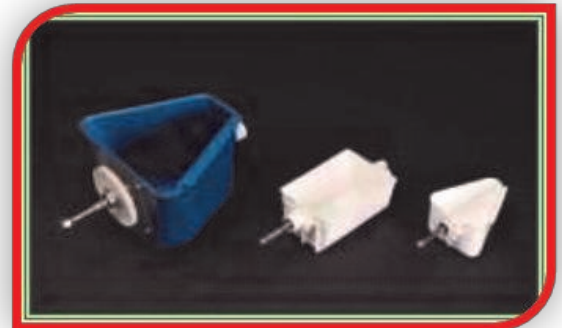
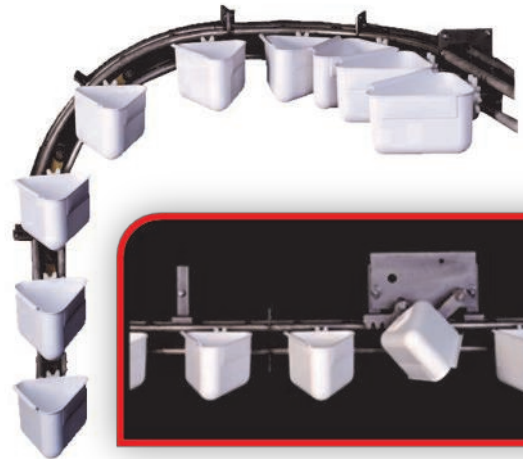

Max Elecon	Pasta Elecon	Elecon
42000ml	9000ml	3600ml

MULTIPLE INLETS & DISCHARGE POINTS FOR A COMPLETELY FLEXIBLE SYSTEM

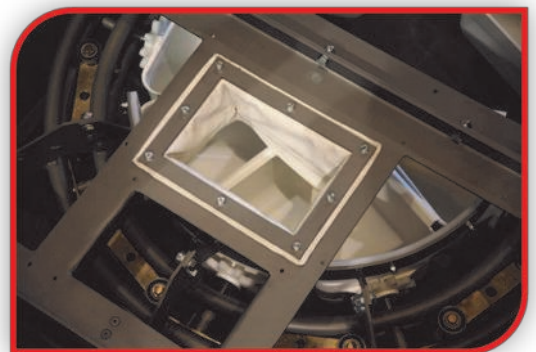
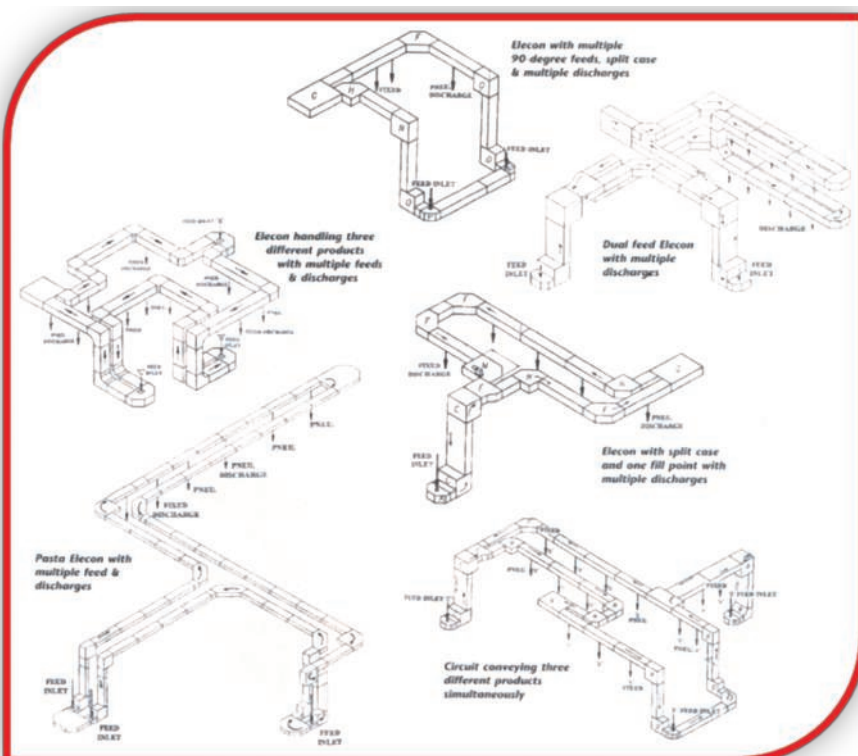

PATENTED SYSTEM



SWINGLINK BUCKET ELEVATORS

- ⇒ Heavy duty chains for long-life durability and reliability.
- ⇒ Constructed of various materials to meet specific process applications including food grade applications
- ⇒ Optional automatic chain cleaning (ChainCare) for maximum cleanliness
- ⇒ Robust unit construction for durability and easy installation
- ⇒ Clean-in-place capabilities for maximum cleanliness
- ⇒ Multiple cover options to meet specific application needs and ensure safety
- ⇒ Buckets remain upright throughout circuit to ensure product integrity
- ⇒ Smooth bucket surfaces eliminate product trap areas
- ⇒ Buckets made from a variety of materials are available to meet specific process requirements
- ⇒ Multiple feed inlets and discharge points for production capabilities
- ⇒ Discharges on lower run of elevator reducing product free-fall drop and increasing product integrity
- ⇒ Durable, yet gentle handling, of customer's product
- ⇒ Robust construction for durability and easy installation.



Features & Benefits

Gough uses the most robust construction & components for reliability and durability.

Gough elevators are designed to handle heavy products such as ammunition.

Perfect for:



Typical Circuit Configurations

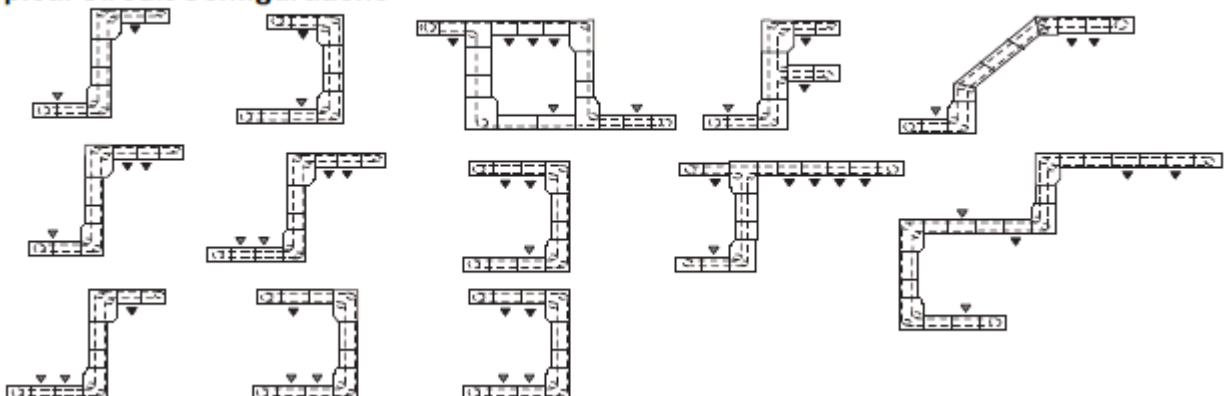



ECON-O-LIFT BUCKET ELEVATORS

This sturdy bucket elevator line is built for durability and easy installation. Econ-O-Lift elevators feature a collapsing chain and 360 degree discharge with multiple discharge and inlet feeds to provide flexibility. Cover options can be provided to meet specific application needs and ensure OHS conformance.

Perfect for:



Construction

- ⇒ Robust construction for durability and easy installation
- ⇒ Multiple discharge and inlet feeds for customer flexibility
- ⇒ Multiple cover options to meet specific application needs and ensure safety

Bucket Design

- ⇒ Buckets remain upright throughout circuit to ensure product integrity
- ⇒ Clean-in-place capabilities for maximum cleanliness
- ⇒ Smooth bucket surfaces eliminate product trap areas
- ⇒ Buckets constructed of various materials to meet specific process applications including food grade applications

Patented Chain Design

- ⇒ Heavy-duty chains for increased throughputs and increased production rates
- ⇒ Chains constructed of various materials to meet specific process applications and ensure long-life durability and reliability
- ⇒ Wash-through chain design for maximum cleanliness and superior sanitation

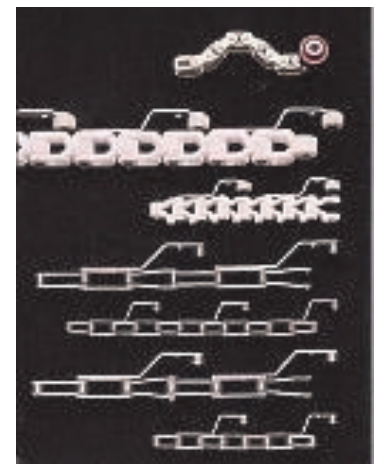

Smart thinking
in motion



**AUSTRALIS
ENGINEERING**

Contact Australis Engineering at:

P +61 2 9707 5888

E sales@australiseng.com.au

W australiseng.com.au